

The LOGAN 1,532 SQ.FT.



FRONT ELEVATION

Home Specifications

WIDTH	51'10"
DEPTH	44'4"
SQUARE FOOTAGE	1,532
TOTAL HEATED	1,532 SQ.FT.
FIRST FLOOR	1,532 SQ.FT.
TOTAL UNHEATED	585 SQ.FT.
GARAGE	465 SQ.FT.
FRONT PORCH	20 SQ.FT.
DECK	100 SQ.FT.

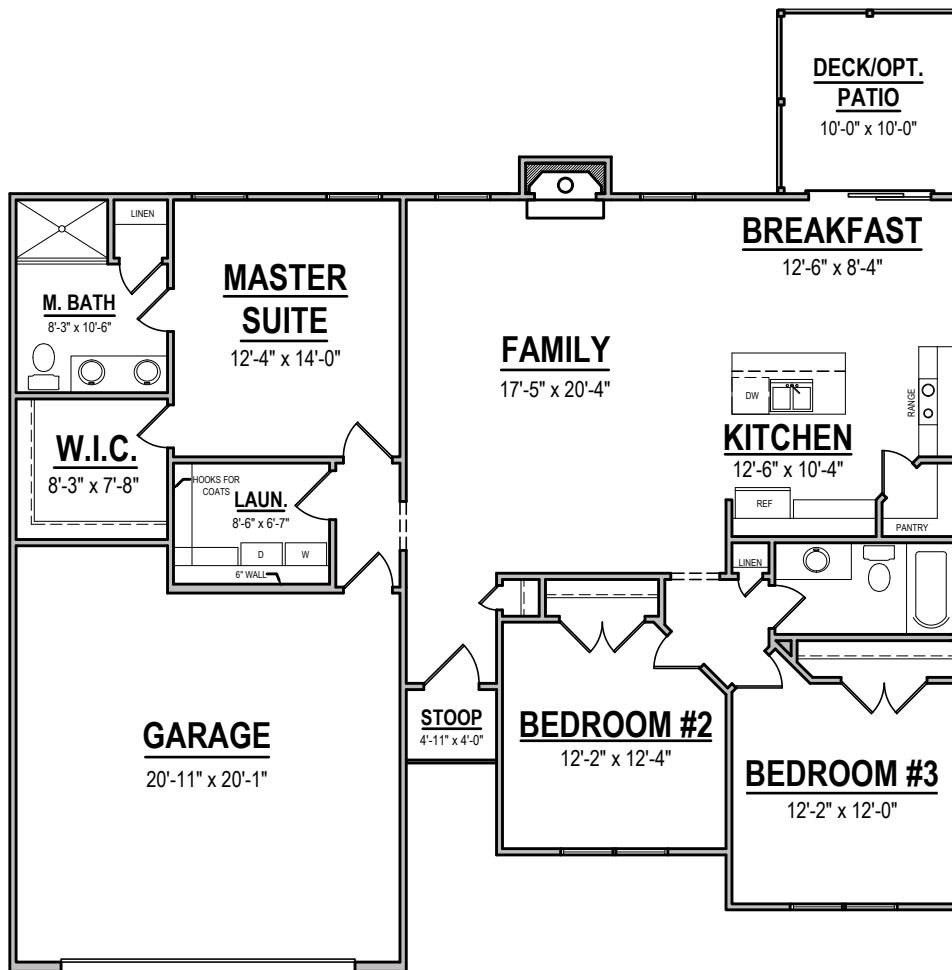

FIRST FLOOR



SIGNATURE
HOME BUILDERS, INC.

*Signature*HOMEBUILDERS.COM

1209 N. Main Street, Lillington, NC 27546 | Phone 910-892-9299 | Fax 910-892-9242